

DRAWING NUMBER:	01-1111-1-XX
PRODUCT GROUP:	BINDING POSTS
SUB-GROUP:	COMMERCIAL BINDING POSTS
DESCRIPTION:	SHORTING LINK FOR DUAL BINDING POST

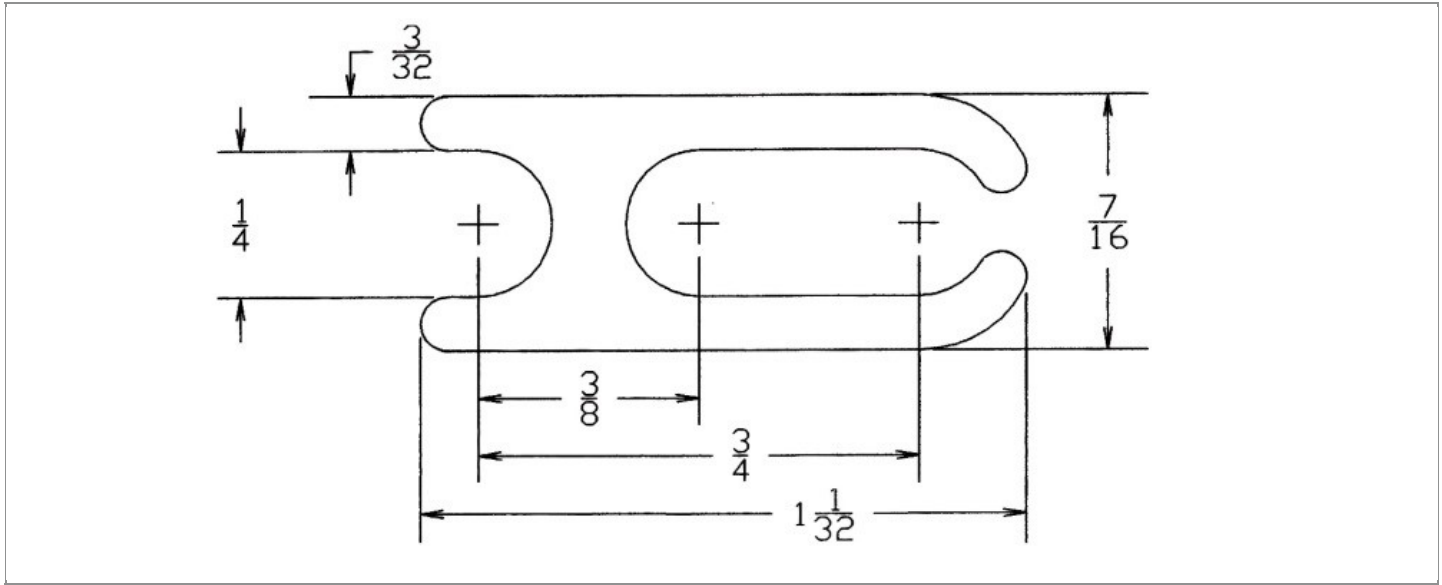

ACCEPTS PIN / PLUG / JACK SIZE	OVERALL LENGTH	BOARD / PANEL MOUNTING METHOD
N/A	1.031" x 0.031"	N/A
MOUNTING HOLE SIZE	DRILL SIZE	BOARD / PANEL THICKNESS
N/A	N/A	N/A

PART NO. STRUCTURE:

01-1111	-	1	-	XX
PART SERIES		DIMENSION		FINISH

MATERIAL OPTIONS:

01-1111-1-XX

COMPONENT	MATERIAL	MATERIAL AND SPECIFICATION
BODY	SPRING BRASS	BRASS PER ASTM B36, ALLOY C26000
HEAD	N/A	N/A
INSULATION	N/A	N/A
JACK SPRING	N/A	N/A
NUT	N/A	N/A
WASHER	N/A	N/A

FINISH - PLATING OPTIONS:

01-1111-1-XX

FINISH CODE	COMPONENT	FINISH	FINISH AND SPECIFICATION
02	BODY	NICKEL	0.000100"MIN. NICKEL PER SAE-AMS-QQ-N-290
	HEAD	N/A	N/A
	JACK SPRING	N/A	N/A
	NUT	N/A	N/A
	WASHER	N/A	N/A
03	BODY	GOLD	GOLD FLASH PER ASTM B488, TYPE II, CODE C OVER NICKEL PER SAE-AMS-QQ-N-290
	HEAD	N/A	N/A
	JACK SPRING	N/A	N/A
	NUT	N/A	N/A
	WASHER	N/A	N/A

TOLERANCES:*

DECIMAL	FRACTIONAL	ANGULAR	DRAWING ORIGATION DATE	LAST MODIFICATION DATE
± 0.010	± 1/64	N/A	11/14/1997	5/1/2017

*All dimensions are in inches.

RoHS COMPLIANCE:

01-1111-1-XX

PART NUMBER	RoHS COMPLIANT
01-1111-1-02	YES
01-1111-1-03	YES

NOTES:

DATASHEET NOTES
N/A
INSTRUCTION NOTES
N/A