

<b>DRAWING NUMBER:</b>	<b>15-141-X-XX</b>
<b>PRODUCT GROUP:</b>	TERMINALS
<b>SUB-GROUP:</b>	MILITARY NON-INSULATED TERMINALS
<b>DESCRIPTION:</b>	NON-INSULATED TURRET TERMINAL

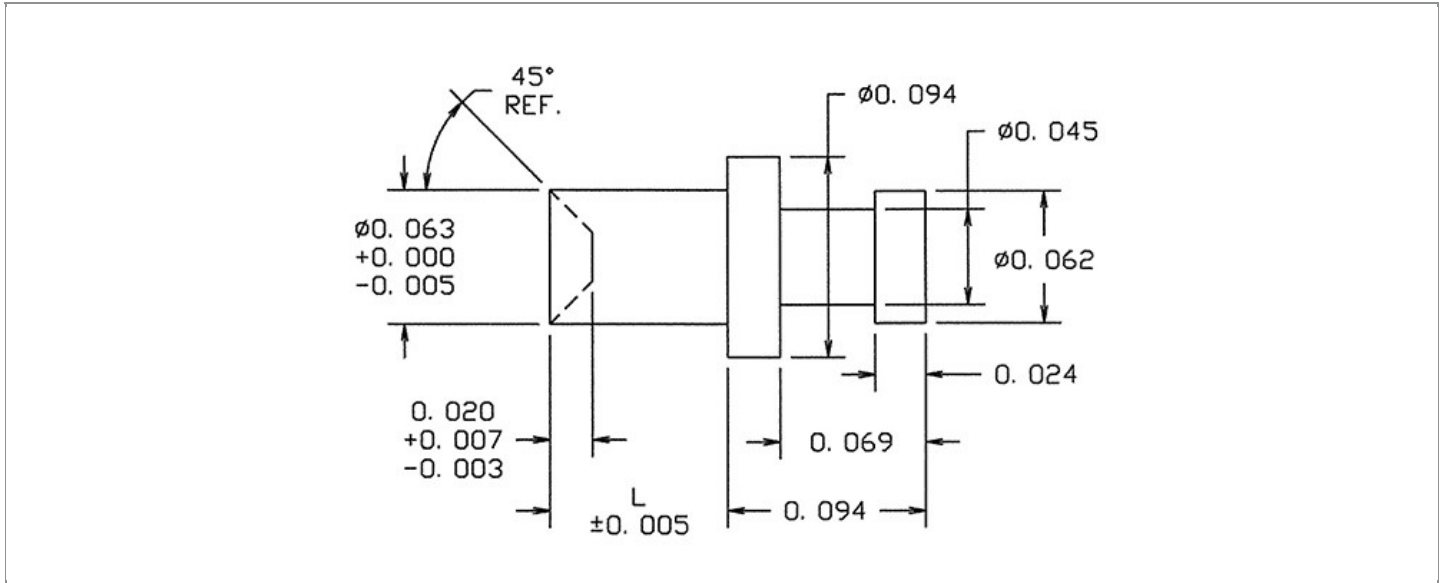

BOARD / PANEL MOUNTING METHOD	MOUNTING HOLE SIZE	DRILL SIZE	FEED THRU COMBINATION
SWAGE MOUNT	0.067" ± 0.001	#51	N/A

**PART NO. STRUCTURE:**

15-141 - X - XX  
 PART SERIES    DIMENSION    FINISH

**MATERIAL OPTIONS:**

15-141-X-XX

COMPONENT	MATERIAL	MATERIAL AND SPECIFICATION
TERMINAL	BRASS	BRASS PER ASTM B16, ALLOY C36000, 1/2 HARD

**DIMENSION OPTIONS:**

15-141-X-XX

DIMENSION	K	OVERALL LENGTH	SHANK LENGTH (L)	BOARD/PANEL THICKNESS
1	N/A	0.147"	0.053"	1/32"
2	N/A	0.178"	0.084"	1/16"
3	N/A	0.209"	0.115"	3/32"
4	N/A	0.241"	0.147"	1/8"

FINISH - PLATING OPTIONS:

15-141-X-XX

FINISH CODE	COMPONENT	FINISH	FINISH AND SPECIFICATION
05	TERMINAL	ELECTRO-SOLDER	0.000300"MIN. ELECTRO-SOLDER PER SAE-AMS-P-81728 OVER 0.000100"MIN. COPPER PER SAE-AMS-2418
088	TERMINAL	BRIGHT TIN-LEAD	0.000300"MIN. BRIGHT TIN-LEAD (Sn93%-Pb7%) PER ASTM B545 OVER 0.000100"MIN. COPPER PER SAE-AMS-2418
095	TERMINAL	HOT SOLDER DIP	0.000100"MIN. HOT SOLDER DIP USING Sn60 PER IPC-J-STD-006 OVER 0.000100"MIN. COPPER PER SAE-AMS-2418

TOLERANCES:\*

DECIMAL	FRACTIONAL	ANGULAR	DRAWING ORIGATION DATE	LAST MODIFICATION DATE
± 0.005	N/A	± 3 °	4/16/1997	3/1/2017

\*All dimensions are in inches.

RoHS COMPLIANCE:

15-141-1-XX

PART NUMBER	RoHS COMPLIANT
15-141-1-05	NO
15-141-1-088	NO
15-141-1-095	NO

15-141-2-XX

PART NUMBER	RoHS COMPLIANT
15-141-2-05	NO
15-141-2-088	NO
15-141-2-095	NO

15-141-3-XX

PART NUMBER	RoHS COMPLIANT
15-141-3-05	NO
15-141-3-088	NO
15-141-3-095	NO

15-141-4-XX

PART NUMBER	RoHS COMPLIANT
15-141-4-05	NO
15-141-4-088	NO
15-141-4-095	NO

MILITARY REFERENCE SPECIFICATIONS:

15-141-1-XX

PART NUMBER	MIL SPECIFICATION	MIL PART NUMBER	COMMERCIAL ITEM DESCRIPTION (CID) SPECIFICATION	CID PART NUMBER
15-141-1-05	MIL-T-55155/11	M55155/11XH04 (M55155/11-4S; SE11XC04S)	A-A-59126/11	AA59126/11XH04
15-141-1-088	MIL-T-55155/11	M55155/11XJ04	A-A-59126/11	AA59126/11XJ04 (AA59126/1104)
15-141-1-095	MIL-T-55155/11	M55155/11XI04	A-A-59126/11	AA59126/11XI04

Continued on next page...

MILITARY REFERENCE SPECIFICATIONS CONTINUED:

15-141-2-XX

PART NUMBER	MIL SPECIFICATION	MIL PART NUMBER	COMMERCIAL ITEM DESCRIPTION (CID) SPECIFICATION	CID PART NUMBER
15-141-2-05	MIL-T-55155/11	M55155/11XH05 (M55155/11-5S; SE11XC05S)	A-A-59126/11	AA59126/11XH05
15-141-2-088	MIL-T-55155/11	M55155/11XJ05	A-A-59126/11	AA59126/11XJ05 (AA59126/1105)
15-141-2-095	MIL-T-55155/11	M55155/11XI05	A-A-59126/11	AA59126/11XI05

15-141-3-XX

PART NUMBER	MIL SPECIFICATION	MIL PART NUMBER	COMMERCIAL ITEM DESCRIPTION (CID) SPECIFICATION	CID PART NUMBER
15-141-3-05	MIL-T-55155/11	M55155/11XH06 (M55155/11-6S; SE11XC06S)	A-A-59126/11	AA59126/11XH06
15-141-3-088	MIL-T-55155/11	M55155/11XJ06	A-A-59126/11	AA59126/11XJ06 (AA59126/1106)
15-141-3-095	MIL-T-55155/11	M55155/11XI06	A-A-59126/11	AA59126/11XI06

15-141-4-XX

PART NUMBER	MIL SPECIFICATION	MIL PART NUMBER	COMMERCIAL ITEM DESCRIPTION (CID) SPECIFICATION	CID PART NUMBER
15-141-4-05	MIL-T-55155/11	M55155/11XH07 (M55155/11-7S; SE11XC07S)	A-A-59126/11	AA59126/11XH07
15-141-4-088	MIL-T-55155/11	M55155/11XJ07	A-A-59126/11	AA59126/11XJ07 (AA59126/1107)
15-141-4-095	MIL-T-55155/11	M55155/11XI07	A-A-59126/11	AA59126/11XI07

TOOLING:

INSTALLATION TOOL: ARBOR PRESS	INSTALLATION TOOL: ANVIL (ARBOR PRESS OPERATED)	INSTALLATION TOOL: PRESS-FIT / ROLL SWAGE / RIVET PUNCH (ARBOR PRESS OPERATED)	INSTALLATION TOOL: FLARE SWAGE PUNCH (ARBOR PRESS OPERATED)
TM1	TA94-62-20	TP10-141	N/A

NOTES:

<b>DATASHEET NOTES</b>
N/A
<b>INSTRUCTION NOTES</b>
SEE GENERAL SWAGING INSTALLATION INSTRUCTION ON CONCORD ELECTRONICS' WEBSITE <a href="http://WWW.CONCORD-ELECTRONICS.COM">WWW.CONCORD-ELECTRONICS.COM</a>