

DRAWING NUMBER:	15-104-X-XX
PRODUCT GROUP:	TERMINALS
SUB-GROUP:	MILITARY NON-INSULATED TERMINALS
DESCRIPTION:	NON-INSULATED TURRET TERMINAL

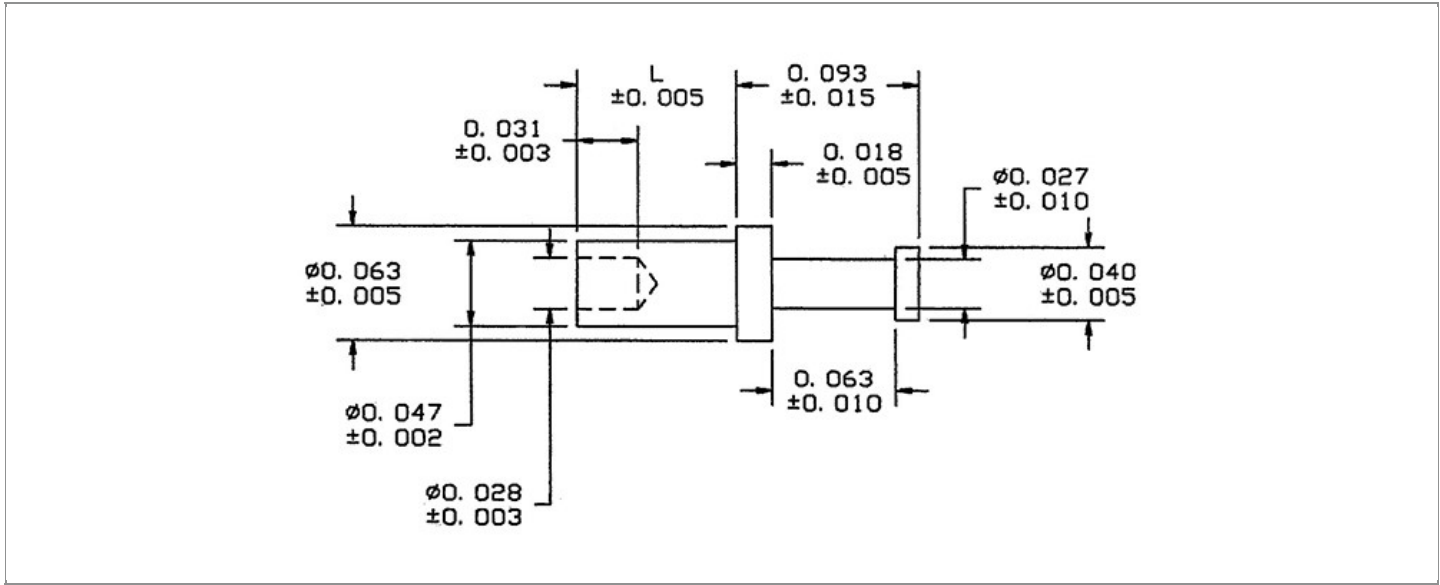

BOARD / PANEL MOUNTING METHOD	MOUNTING HOLE SIZE	DRILL SIZE	FEED THRU COMBINATION
SWAGE MOUNT	0.052" ± 0.001	#55	N/A

PART NO. STRUCTURE:

15-104 - X - XX
 PART SERIES DIMENSION FINISH

MATERIAL OPTIONS:

15-104-X-XX

COMPONENT	MATERIAL	MATERIAL AND SPECIFICATION
TERMINAL	BRASS	BRASS PER ASTM B16, ALLOY C36000, 1/2 HARD

DIMENSION OPTIONS:

15-104-X-XX

DIMENSION	K	OVERALL LENGTH	SHANK LENGTH (L)	BOARD/PANEL THICKNESS
1	N/A	0.144"	0.051"	1/32"
2	N/A	0.175"	0.082"	1/16"
3	N/A	0.206"	0.113"	3/32"
4	N/A	0.238"	0.145"	1/8"
11	N/A	0.128"	0.035"	1/64"

FINISH - PLATING OPTIONS:

15-104-X-XX

FINISH CODE	COMPONENT	FINISH	FINISH AND SPECIFICATION
05	TERMINAL	ELECTRO-SOLDER	0.000300"MIN. ELECTRO-SOLDER PER SAE-AMS-P-81728 OVER 0.000100"MIN. COPPER PER SAE-AMS-2418
088	TERMINAL	BRIGHT TIN-LEAD	0.000300"MIN. BRIGHT TIN-LEAD (Sn93%-Pb7%) PER ASTM B545 OVER 0.000100"MIN. COPPER PER SAE-AMS-2418
095	TERMINAL	HOT SOLDER DIP	0.000100"MIN. HOT SOLDER DIP USING Sn60 PER IPC-J-STD-006 OVER 0.000100"MIN. COPPER PER SAE-AMS-2418

TOLERANCES:*

DECIMAL	FRACTIONAL	ANGULAR	DRAWING ORIGATION DATE	LAST MODIFICATION DATE
± 0.010	± 1/64	± 5 °	4/9/1997	3/1/2017

*All dimensions are in inches.

RoHS COMPLIANCE:

15-104-1-XX

PART NUMBER	RoHS COMPLIANT
15-104-1-05	NO
15-104-1-088	NO
15-104-1-095	NO

15-104-2-XX

PART NUMBER	RoHS COMPLIANT
15-104-2-05	NO
15-104-2-088	NO
15-104-2-095	NO

15-104-3-XX

PART NUMBER	RoHS COMPLIANT
15-104-3-05	NO
15-104-3-088	NO
15-104-3-095	NO

15-104-4-XX

PART NUMBER	RoHS COMPLIANT
15-104-4-05	NO
15-104-4-088	NO
15-104-4-095	NO

15-104-11-XX

PART NUMBER	RoHS COMPLIANT
15-104-11-05	NO
15-104-11-088	NO
15-104-11-095	NO

MILITARY REFERENCE SPECIFICATIONS:

15-104-1-XX

PART NUMBER	MIL SPECIFICATION	MIL PART NUMBER	COMMERCIAL ITEM DESCRIPTION (CID) SPECIFICATION	CID PART NUMBER
15-104-1-05	MIL-T-55155/29	M55155/29XH02 (M55155/29-2S; SE29XC02S)	A-A-59126/29	AA59126/29XH02
15-104-1-088	MIL-T-55155/29	M55155/29XJ02	A-A-59126/29	AA59126/29XJ02 (AA59126/2902)
15-104-1-095	MIL-T-55155/29	M55155/29XI02	A-A-59126/29	AA59126/29XI02

Continued on next page...

MILITARY REFERENCE SPECIFICATIONS CONTINUED:

15-104-2-XX

PART NUMBER	MIL SPECIFICATION	MIL PART NUMBER	COMMERCIAL ITEM DESCRIPTION (CID) SPECIFICATION	CID PART NUMBER
15-104-2-05	MIL-T-55155/29	M55155/29XH05 (M55155/29-5S; SE29XC05S)	A-A-59126/29	AA59126/29XH05
15-104-2-088	MIL-T-55155/29	M55155/29XJ05	A-A-59126/29	AA59126/29XJ05 (AA59126/2905)
15-104-2-095	MIL-T-55155/29	M55155/29XI05	A-A-59126/29	AA59126/29XI05

15-104-3-XX

PART NUMBER	MIL SPECIFICATION	MIL PART NUMBER	COMMERCIAL ITEM DESCRIPTION (CID) SPECIFICATION	CID PART NUMBER
15-104-3-05	MIL-T-55155/29	M55155/29XH08 (M55155/29-8S; SE29XC08S)	A-A-59126/29	AA59126/29XH08
15-104-3-088	MIL-T-55155/29	M55155/29XJ08	A-A-59126/29	AA59126/29XJ08 (AA59126/2908)
15-104-3-095	MIL-T-55155/29	M55155/29XI08	A-A-59126/29	AA59126/29XI08

15-104-4-XX

PART NUMBER	MIL SPECIFICATION	MIL PART NUMBER	COMMERCIAL ITEM DESCRIPTION (CID) SPECIFICATION	CID PART NUMBER
15-104-4-05	MIL-T-55155/29	M55155/29XH11 (M55155/29-11S; SE29XC11S)	A-A-59126/29	AA59126/29XH11
15-104-4-088	MIL-T-55155/29	M55155/29XJ11	A-A-59126/29	AA59126/29XJ11 (AA59126/2911)
15-104-4-095	MIL-T-55155/29	M55155/29XI11	A-A-59126/29	AA59126/29XI11

15-104-11-XX

PART NUMBER	MIL SPECIFICATION	MIL PART NUMBER	COMMERCIAL ITEM DESCRIPTION (CID) SPECIFICATION	CID PART NUMBER
15-104-11-05	MIL-T-55155/29	M55155/29XH01 (M55155/29-1S; SE29XC01S)	A-A-59126/29	AA59126/29XH01
15-104-11-088	MIL-T-55155/29	M55155/29XJ01	A-A-59126/29	AA59126/29XJ01 (AA59126/2901)
15-104-11-095	MIL-T-55155/29	M55155/29XI01	A-A-59126/29	AA59126/29XI01

TOOLING:

INSTALLATION TOOL: ARBOR PRESS	INSTALLATION TOOL: ANVIL (ARBOR PRESS OPERATED)	INSTALLATION TOOL: PRESS-FIT / ROLL SWAGE / RIVET PUNCH (ARBOR PRESS OPERATED)	INSTALLATION TOOL: FLARE SWAGE PUNCH (ARBOR PRESS OPERATED)
TM1	TA62-40-18	TP47-26	TFLP90-150

NOTES:

DATASHEET NOTES

N/A

INSTRUCTION NOTES

SEE GENERAL SWAGING INSTALLATION INSTRUCTION ON CONCORD ELECTRONICS' WEBSITE WWW.CONCORD-ELECTRONICS.COM
