

<b>DRAWING NUMBER:</b>	<b>09-9124-1-XXXX</b>
<b>PRODUCT GROUP:</b>	PANEL JACKS AND TERMINALS
<b>SUB-GROUP:</b>	PANEL JACKS AND TERMINALS - THREAD MOUNT
<b>DESCRIPTION:</b>	PANEL JACK - METAL THREAD

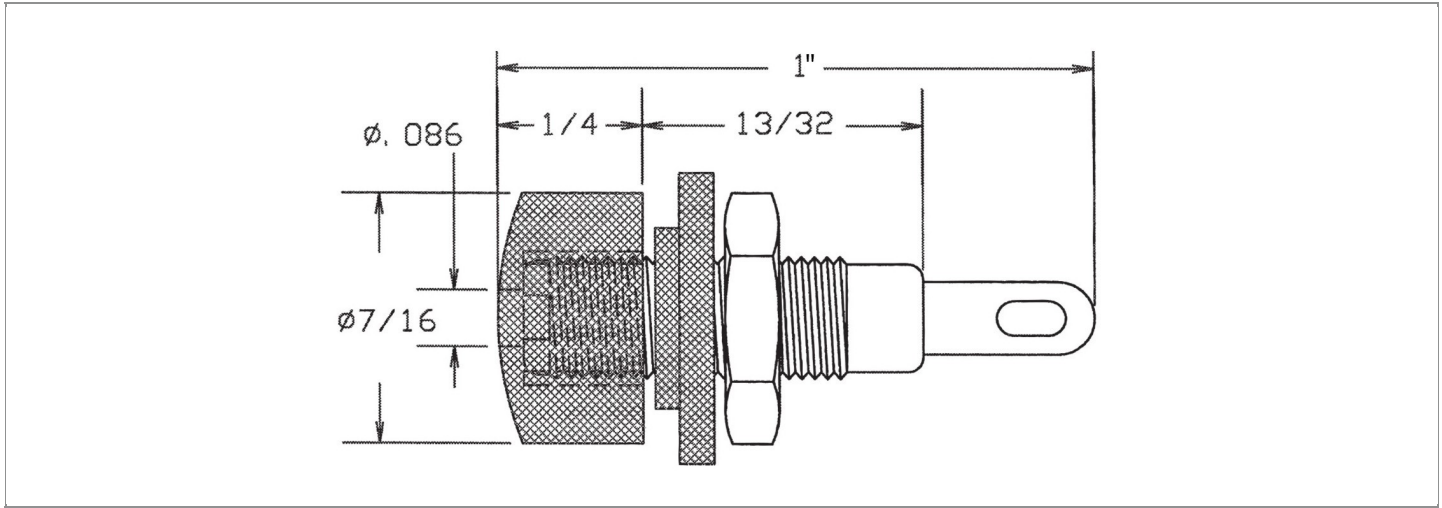

ACCEPTS PIN / PLUG / JACK SIZE	MIN. HOLE DEPTH	MOUNTING ORIENTATION	BOARD / PANEL MOUNTING METHOD
0.080" ± 0.001	0.550"	VERTICAL	THREAD MOUNT (1/4-32 NUT)
MOUNTING HOLE SIZE	BOARD / PANEL THICKNESS	FEED THRU COMBINATION	OVERALL LENGTH
0.257" ± 0.002	UP TO 1/8"	JACK/EYELET	1.000"

**PART NO. STRUCTURE:**

<b>09-9124</b>	-	<b>1</b>	-	<b>XX</b>	<b>XX</b>
PART SERIES		DIMENSION		FINISH	INSULATION COLOR

**MATERIAL OPTIONS:**

**09-9124-1-XXXX**

COMPONENT	MATERIAL	MATERIAL AND SPECIFICATION
BODY	N/A	N/A
SPRING (CAGE)	PHOSPHOR BRONZE	PHOSPHOR BRONZE
INSULATION*	NYLON	NYLON
BASE/METAL SLEEVE	N/A	N/A
NUT	BRASS	BRASS
WASHER	FIBER	FIBER
LUG	N/A	N/A

\*For Insulation color, please see INSULATION COLOR OPTIONS on Page 2

FINISH - PLATING OPTIONS:

09-9124-1-XXXX

FINISH CODE	COMPONENT	FINISH	FINISH AND SPECIFICATION
02	BODY	N/A	N/A
	SPRING (CAGE)	UNPLATED	UNPLATED
	BASE/METAL SLEEVE	NICKEL	NICKEL
	NUT	NICKEL	NICKEL
	WASHER	N/A	N/A
	LUG	N/A	N/A

INSULATION COLOR OPTIONS:

09-9124-1-XXXX

INSULATION COLOR	BLACK	RED
COLOR CODE NO.	10	12

TOLERANCES:\*

DECIMAL	FRACTIONAL	ANGULAR	DRAWING ORIGATION DATE	LAST MODIFICATION DATE
± 0.010	± 1/64	± 5 °	10/28/1998	1/1/2017

\*All dimensions are in inches.

RoHS COMPLIANCE:

09-9124-1-02XX

PART NUMBER	RoHS COMPLIANT
09-9124-1-0210	YES
09-9124-1-0212	YES

MILITARY REFERENCE SPECIFICATIONS:

09-9124-1-02XX

PART NUMBER	MIL SPECIFICATION	MIL PART NUMBER
09-9124-1-0210	N/A	N/A
09-9124-1-0212	N/A	N/A

**NOTES:**

---

**DATASHEET NOTES**

N/A

---

**INSTRUCTION NOTES**

SUPPLIED WITH NICKEL PLATED BRASS HEX NUT (1/4-32) AND FIBER WASHER.

---